

# MPPT Solar Adapter

## SC600

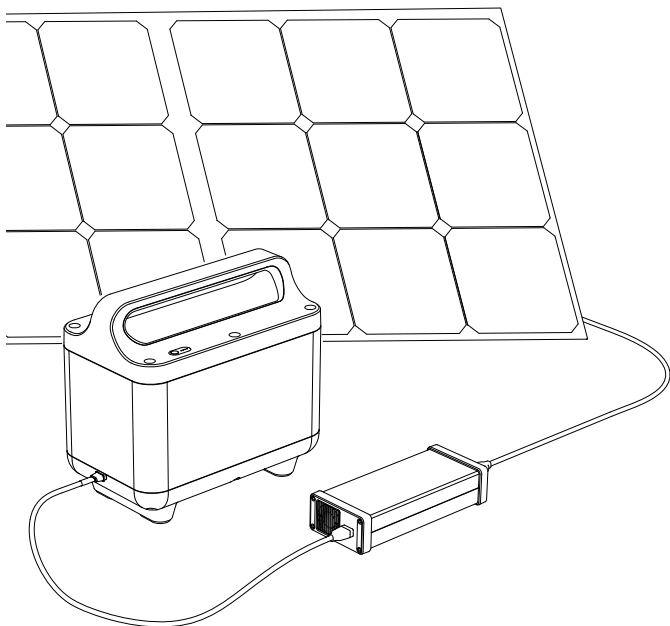

- When the product fails, in order to reduce the risk of electric shock, please remove the power station from the socket before performing any guided maintenance operations.
- Please charge the product in a well-ventilated place, do not obstruct the air circulation.
- Under some extremely harsh conditions, liquid may be ejected from the battery. Avoid contact with batteries and liquids. If contacted please rinse with plenty of water. If the liquid comes into contact with the eyes, please seek other medical help.
- Please do not expose the product to fire or excessive heat.
- Only repairs by qualified service personnel.

### Introduction

The SC600 is a MPPT solar adapter designed for BT01 batteries to be charged using solar panels and car chargers. Please check the correct input parameters and connect the correct cable to charge.

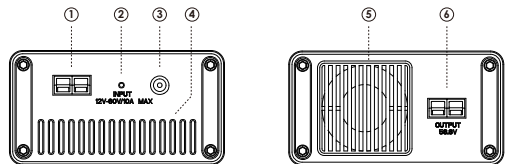

- ① Anderson Input
- ② Indicator
- ③ DC Input
- ④ Air Holes
- ⑤ Cooling Fan
- ⑥ DC Output

### User's Manual



### CAUTION

- Please keep dry and stay away from fire.
- Please do not disassemble, puncture or strongly impact the product.
- Please recycle and dispose of the product in accordance with local laws and regulations.
- Please keep safe when dispose of the product.
- Children and the disabled please use this product with guardian.

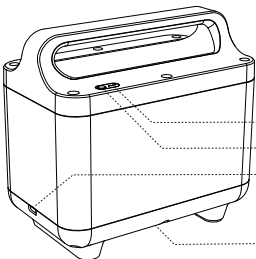

- Battery Main Power LED Indicator
- Battery Power Level Display Button
- Battery Charging Port
- Connector



### Safety Instructions and Maintenance

- Please read the manual carefully before using the product.
- To reduce the risk of injury, please pay more attention when using this product near children.
- Do not put fingers, palms or any part of your body into the product.
- Use the unrecommended accessories may cause fire, electric shock or personal injury.
- Do not use damaged or modified battery packs or devices.
- Do not use this product with damaged wires, plugs or output cables.
- When the product needs repair or maintenance, do not disassemble the power supply by yourself. Please hand the power station to a qualified service provider. Wrong disassembly method may cause the risk of fire or electric shock.

### Specification

Model No.:		SC600
Input	Anderson	12-60V/10A Max ( Max support 600W input )
	DC 5521	12-60V/7A Max ( Max support 420W input )
Output	Anderson	58.8V/10A Max
Peak Power		600W
Accessories		Anderson-XT60 charging cable, User manual

## Charging With Solar Panel

1. Connect the MPPT Solar Adapter and Solar Panel with Anderson or DC charging cable.

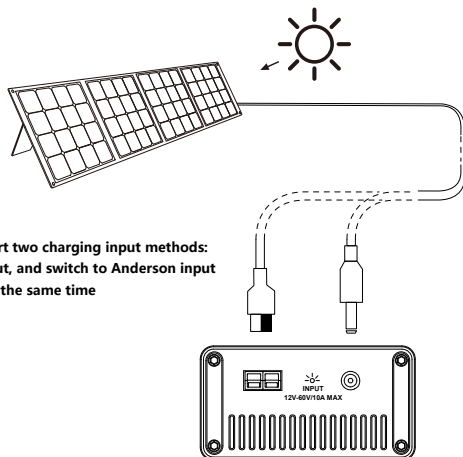

2. Connect the MPPT Solar Adapter and BT01 Battery Pack with Anderson-XT60 charging cable.

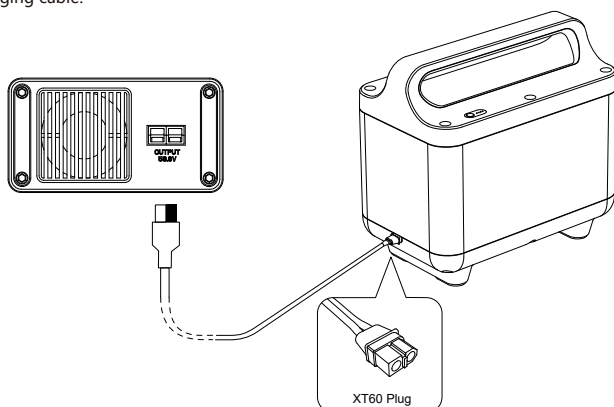

3. The power level indicator corresponding to the battery capacity flashes when charging. After fully charged, all 4 indicators are on.

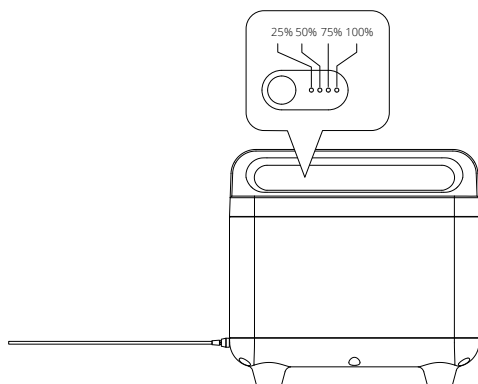

4. When the battery is turned on, the power indicator will always on. Please long press the battery power button 5s to turn off when storing the battery.

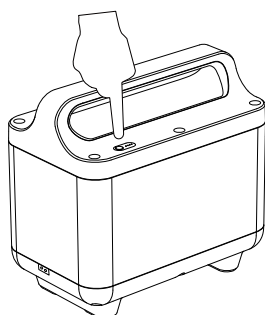

## Charging With Car Socket

1. Connect the MPPT Solar Adapter and Car Socket with DC charging cable. (Additional Purchases)

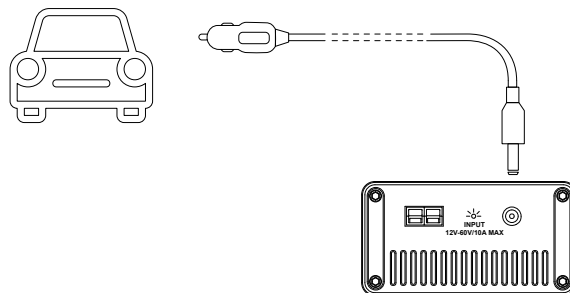

2. Connect the MPPT Solar Adapter and BT01 Battery Pack with Anderson-XT60 charging cable.

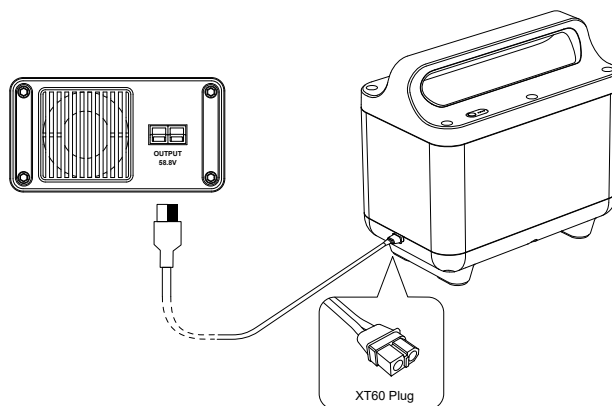

## ATTENTION

1. When the battery pack is fully charged, disconnect the Anderson-XT60 charging cable as soon as possible. Overcharging increases the risk of battery damage if the battery is fully charged and continues to be charged for a long period of time. In the worst case, the battery may catch fire.
2. When charging the battery pack, use the included charging adapter and cable. If you charge the product with a product other than the specified one, the product may be damaged. In the worst case, it may cause fire, electric shock, or injury.
3. When charging, a sufficient heat dissipation space and a place where air can pass are required. Never block or cover the air intake and heat dissipation fan of the SC600 charging adapter.
4. The SC600 charging adapter has a certain amount of heat during charging. Please note that touching the surface of the charging adapter for a long time may cause burns. Also, do not place or lean the charging adapter on anything that is sensitive to heat.
5. When charging, take appropriate waterproof and fire prevention measures so that the product will not get wet in the rain or come close to firearms.
6. When the battery power button is turned on, the battery level indicator lamp is always lit. When you put away the battery pack, press and hold the battery power button to turn it off.

## ATTENTION

1. Why does it make a noise when charging?  
 This is the sound of the heat dissipation fan built into this product spinning. By rotating the heat dissipation fan during use, it has the role of releasing the heat accumulated in the main body to the outside and making it difficult for the temperature to rise.
2. Is it normal for the charging adapter to get hot during charging?  
 If the surface temperature of the adapter falls below 75 ° C during charging, it is within the safety standard range and you can use it with confidence.
3. Where should I store this product?  
 Store in a place where air can pass and moisture does not accumulate as much as possible. Proper storage can extend its useful life.
4. How can I clean the product if it gets dirty?  
 Wipe it off with a dry, fine-grained cloth or towel. Do not wipe with water or a cloth containing detergent. For a cleaner wipe, we recommend using a cotton swab containing a small amount of anhydrous alcohol. Do not expose the product to large amounts of water.